

## 17TH-19TH CENTURIES

**Cherish**  
the past  
**Embrace**  
the future

The two **bread shelves** either side of the north door, and the **benefactors' board** above the kitchenette, record charitable donations made to **support poor people** of the parish. The money, now invested in **Mottram Parish Charities**, is still used to this day to support needy elderly people in the area.

The shelves were still used until the middle of the 20th century. At **various times** they have been situated on the **south wall**, either side of the door into the **tower**, and fixed on the pillars next to the **cross aisle**.



heritage open days



## OUR PLANS FOR THE NORTH WEST CORNER

**Cherish**  
the past  
**Embrace**  
the future

We propose to open up this area completely - **removing the wooden frontals** that at present impede access to the area, and lowering the **floor level** to match that in the aisles. There would be a **new, more compact servery**.

By **removing some pews** from this end of the north aisle, we could make the space large enough to place **tables and chairs** for cafe-style catering after **church services** or **open days** like today.

You can see from the **area marked with yellow tape**, how much space this will create.

**We think this will be good for everyone, providing a space where friendships can flourish, and social isolation eased. Providing better hospitality will benefit all who come to services and events.**

**The space could also be used for meetings and events organised by the church or community organisations.**

**We'd love to know what you think:**

~ Fill in a paper or on-line **questionnaire** ~ Pop a disk into one of the **voting boxes** ~ Leave a **post-it** comment on one of the white boards ~ [mottramparish.org.uk/heritage/bigplan](http://mottramparish.org.uk/heritage/bigplan)

heritage open days



## 20TH CENTURY

**Cherish**  
the past  
**Embrace**  
the future

Some **pews were removed** from the north west corner in 1982 to make space for a **social area**. This was improved greatly by the addition of the **kitchenette** in 2000.

**Guide books**, homemade cards and other items are **sold** from the units in the north west corner.

For **families** with small children, this small **carpeted area** is suitable for toddlers who like to crawl on the floor.

When we have **exhibitions**, such as this one, and when we have our occasional **book stall**, we use boards and display stands **balanced across the pews** in the north and south aisles.

*continued*

heritage open days



## 20TH CENTURY

*continued*

**Cherish**  
the past  
**Embrace**  
the future

The **'Ruth' window** came from **St. George's Old Church**, Stalybridge in 1970 when that church closed.

The **newest window** is at the far end of the aisle. It was made from the **vandalised** pieces of a window from the **tower** in 1996.

heritage open days

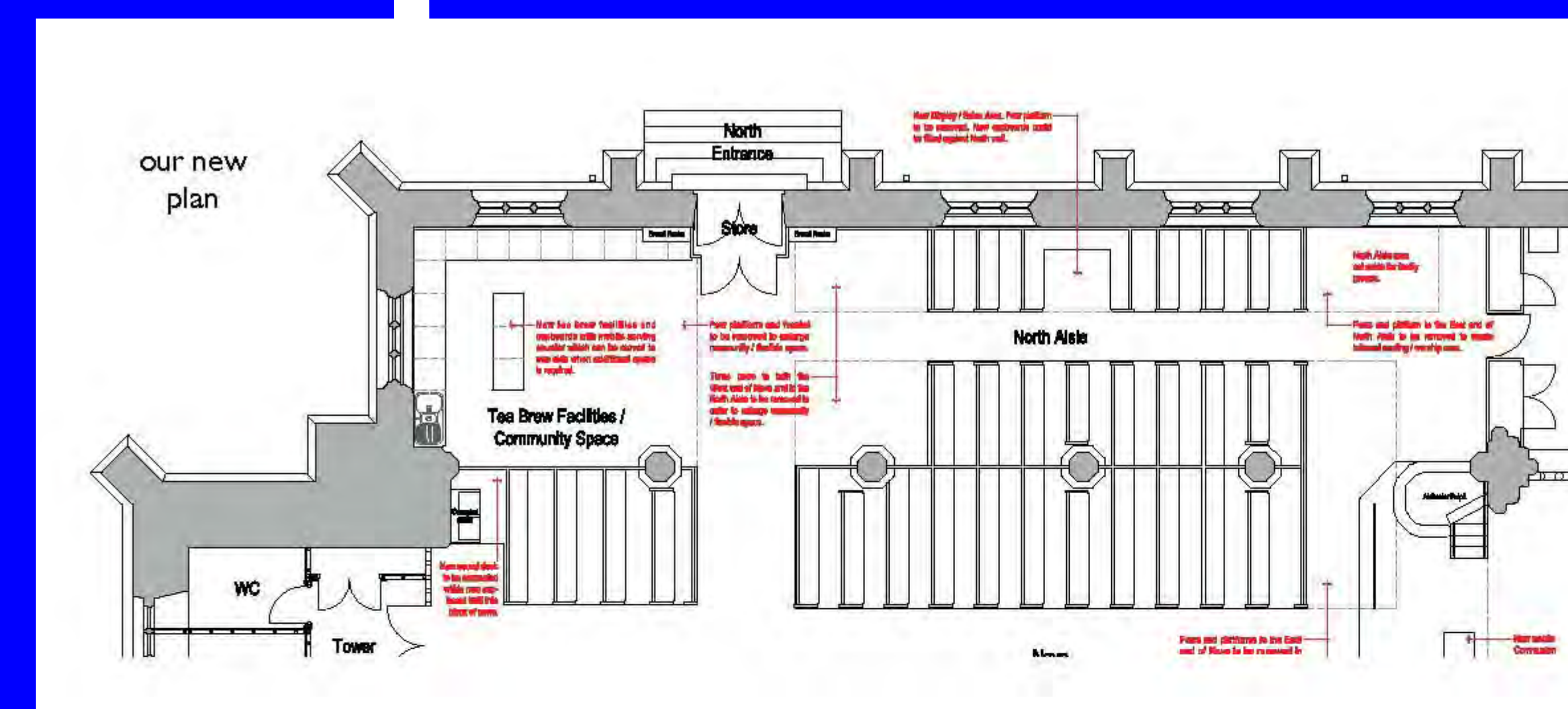
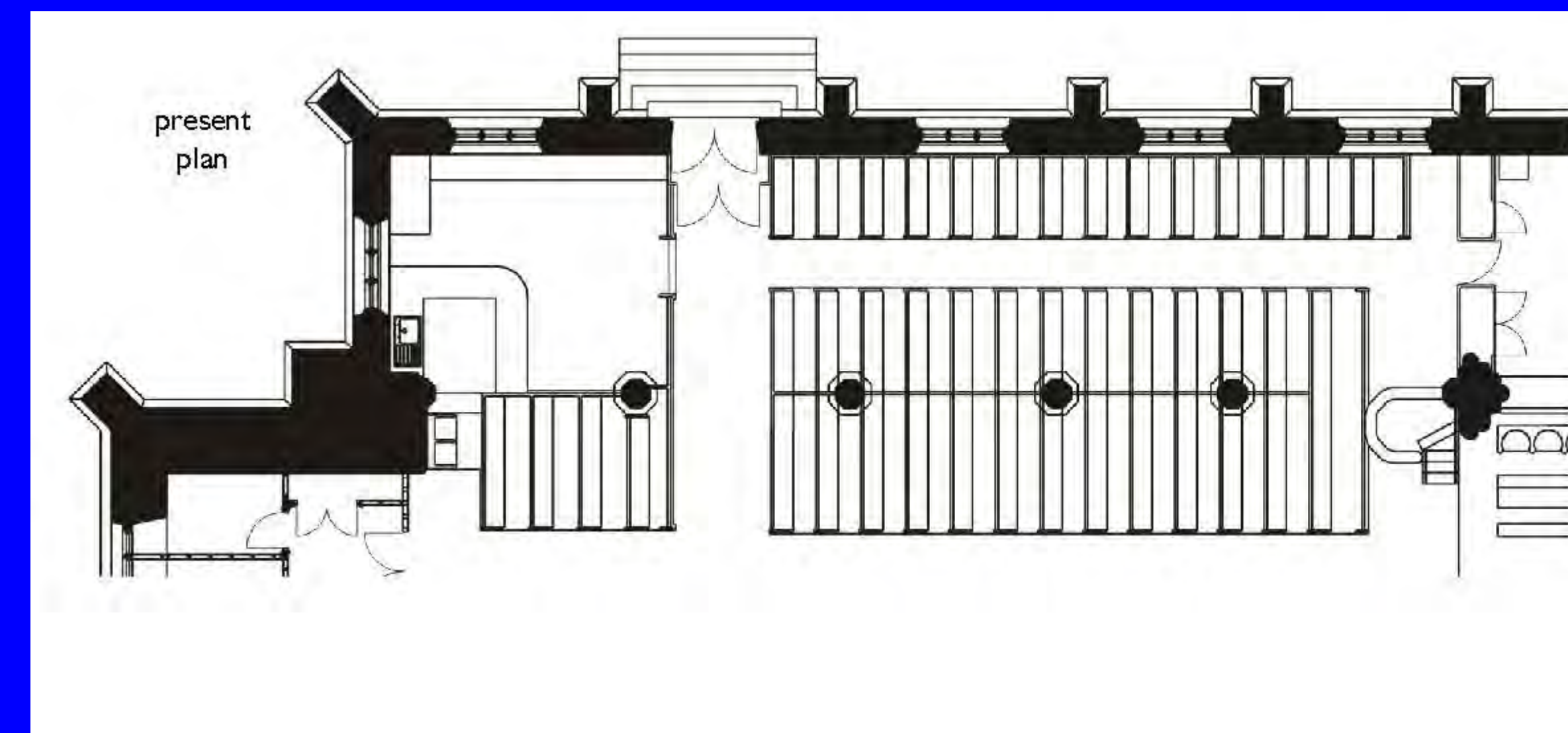

## OUR PLANS FOR THE NORTH AISLE

**Cherish**  
the past  
**Embrace**  
the future

We want to **remove some of the pews** in the middle of this aisle, to create a dedicated **sales and display** area for Guide Books, Christian books, greetings cards and other items.

We want to make a special open, carpeted, **family-friendly** area at the end of the **north aisle** nearest the **pulpit**.

You can see from the **areas marked with yellow tape**, how much space this will create.

**We think that a permanent sales and display area will provide a resource to the congregation and visitors all the year round.**

**The family area will enable those with small children to take a full part in worship and other events, and be able to see all that is happening.**

**We'd love to know what you think:**

~ Fill in a paper or on-line **questionnaire** ~ Pop a disk into one of the **voting boxes** ~ Leave a **post-it** comment on one of the white boards ~ [mottramparish.org.uk/heritage/bigplan](http://mottramparish.org.uk/heritage/bigplan)

heritage open days